



jordan fishwick

Oakmere Spath Lane, SK9 3NS
50% Shared Ownership £86,250



Spath Lane Handforth SK9 3NS

50% Shared Ownership
£86,250



A fantastic and rare opportunity to purchase a 50% Shared Ownership ground floor two bedroom retirement apartment. Forming part of Oakmere retirement living development in Handforth this beautifully presented ground floor apartment has access to communal gardens, a highly sought after feature for buyers. This extremely sought after development offers an array of resident amenities on site which include a gymnasium, craft room, residents lounge, lifts to all floors, beautifully tended communal gardens, operational reception and laundry facilities. There is a real sense of community within the development with a range of technical care support packages for residents. Internally the apartment consists of a spacious entrance hallway with automatic door, two bedrooms, a modern wet room with access via the hallway and principal bedroom. Spacious living room with feature fireplace and patio doors which lead to the communal gardens. The modern fitted kitchen with space for appliances completes the internal specifications. Externally there are beautifully maintained communal gardens and residents car park. The development is secured via automatic doors and a phone entry system with an operational reception during 9.00am to 5.00pm weekdays.

Rent £333.06 Service Charge £646.65 Variable Service Charge £221.93



- No Chain
- Shared Ownership
- Two Bedroom Apartment
- Ground Floor
- Popular Development
- Retirement Living
- Communal Gardens



Energy Efficiency Rating		
	Current	Potential
Very energy efficient - lower running costs		
(92 plus) A		
(81-91) B		
(69-80) C	80	80
(55-68) D		
(39-54) E		
(21-38) F		
(1-20) G		
Not energy efficient - higher running costs		
England & Wales	EU Directive 2002/91/EC	



GROUND FLOOR

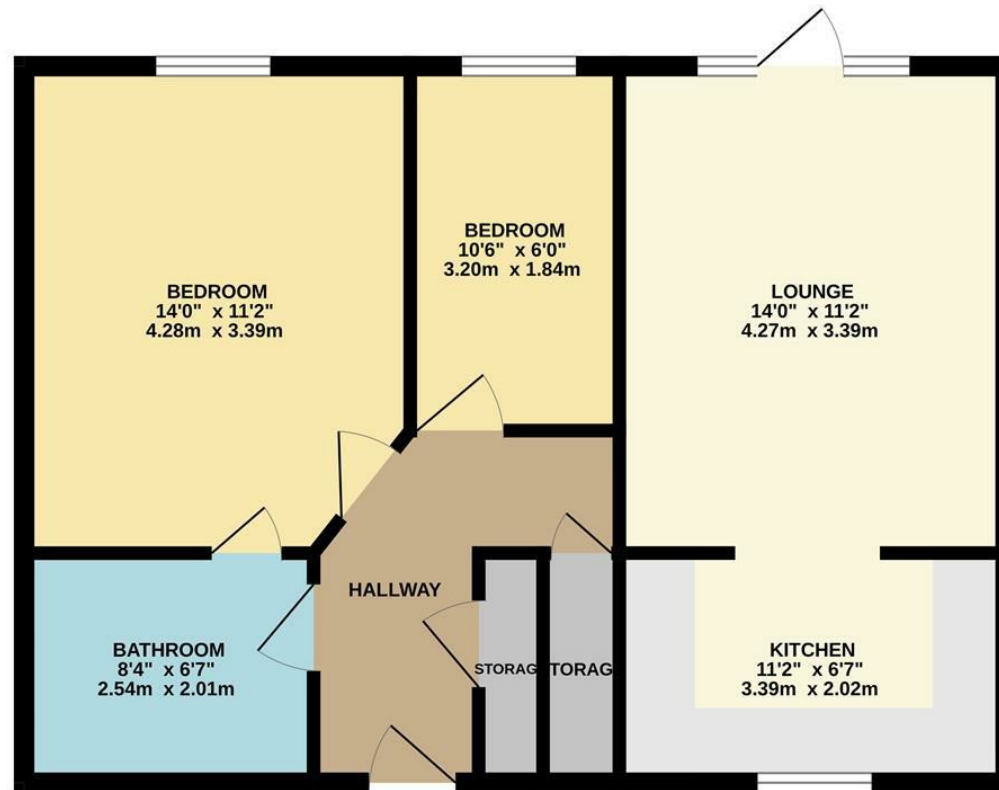

Measurements are approximate. Not to scale. Illustrative purposes only
Made with Metropix ©2025



These particulars are believed to be accurate but they are not guaranteed and do not form a contract. Neither Jordan Fishwick nor the vendor or lessor accept any responsibility in respect of these particulars, which are not intended to be statements or representations of fact and any intending purchaser or lessee must satisfy himself by inspection or otherwise as to the correctness of each of the statements contained in these particulars. Any floorplans on this brochure are for illustrative purposes only and are not necessarily to scale.

Offices at: Chorlton, Didsbury, Disley, Hale, Glossop, Macclesfield, Manchester Deansgate, Manchester Whitworth Street, New Mills, Sale, Wilmslow and Withington

36-38 Alderley Road, Wilmslow SK91JX

01625 532000

wilmslow@jordanfishwick.co.uk

www.jordanfishwick.co.uk